

**RUTHERFORD AND  
SON; A PLAY IN  
THREE ACTS**

Published @ 2017 Trieste Publishing Pty Ltd

ISBN 9780649756414

Rutherford and son; a play in three acts by Githa Sowerby

Except for use in any review, the reproduction or utilisation of this work in whole or in part in any form by any electronic, mechanical or other means, now known or hereafter invented, including xerography, photocopying and recording, or in any information storage or retrieval system, is forbidden without the permission of the publisher, Trieste Publishing Pty Ltd, PO Box 1576 Collingwood, Victoria 3066 Australia.

All rights reserved.

Edited by Trieste Publishing Pty Ltd.  
Cover @ 2017

This book is sold subject to the condition that it shall not, by way of trade or otherwise, be lent, re-sold, hired out, or otherwise circulated without the publisher's prior consent in any form or binding or cover other than that in which it is published and without a similar condition including this condition being imposed on the subsequent purchaser.

[www.triestepublishing.com](http://www.triestepublishing.com)

**GITHA SOWERBY**

**RUTHERFORD AND  
SON; A PLAY IN  
THREE ACTS**



**RUTHERFORD AND SON**



# RUTHERFORD AND SON

*A PLAY IN THREE ACTS*

BY

GITHA SOWERBY

GEORGE H. DORAN COMPANY  
PUBLISHERS

NEW YORK

1872  
1873

COPYRIGHT, 1912, BY  
GEORGE H. DORAN COMPANY

*All rights reserved.*



## CHARACTERS

JOHN RUTHERFORD,

JOHN, }  
RICHARD, } his Sons.

JANET, his Daughter.

ANN, his Sister.

MARY, young John's Wife.

MARTIN.

MRS. HENDERSON.

SCENE.— *Living room in John Rutherford's house.*

*Two days elapse between Acts I. and II.*

*One night between Acts II. and III.*

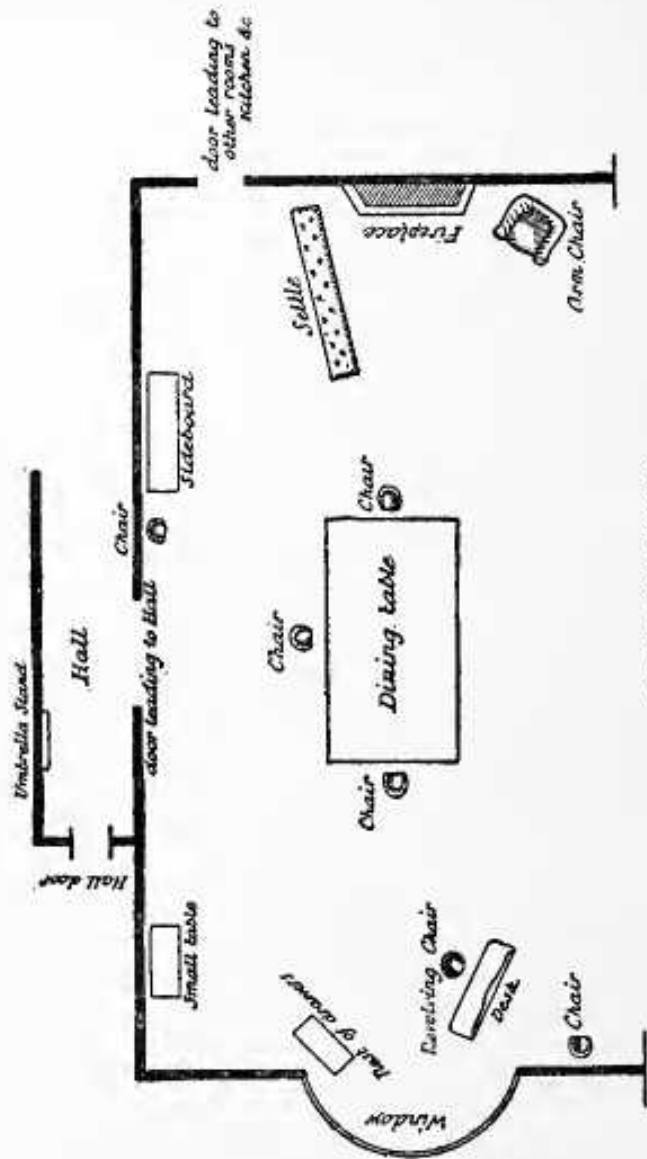

PLAN OF STAGE

# RUTHERFORD AND SON

## ACT I

*John Rutherford's house stands on the edge of the moor, far enough from the village to serve its dignity and near enough to admit of the master going to and from the Works in a few minutes — a process known to the household as "going across." The living room, in which the family life has centred for generations, is a big square room furnished in solid mahogany and papered in red, as if to mitigate the bleakness of a climate that includes five months of winter in every year. There is a big table in the middle of the room covered with a brown cloth at which the family take their meals. An air of orderliness pervades the room, which perhaps accounts for its being extremely uncomfortable. From above the heavy polished sideboard the late John Rutherford looks down from his frame and sees the settle and armchair on either side of the fire, the marble clock on the mantelpiece, the desk with its brass inkstand and*